



PERFIS DE DESLIZAMENTO

APLICAÇÕES

Transportadores de Aço Inox.
Transportadores de Aço Carbono
Transportadores de Alumínio.
Transportadores Aéreos.
Correntes Retas e Curvas.
Esteiras Modulares.
Portas e Fechamentos de Máquina.
Proteções de Superfícies em geral.

VANTAGENS

Excelente transporte do produto.
Vida útil longa.
Maior resistência química.
Maior resistência ao desgaste.
Excelente planicidade.

TRANSPORTE RETO E CURVO

Material: Polietileno

PERFIL L CLIP

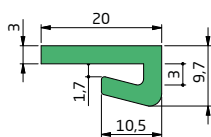

PLC 20-10 | Cód.: 005070

PERFIL Z CLIP

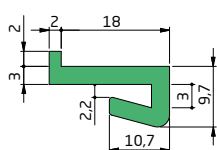

PZC 20-10 | Cód.: 005095

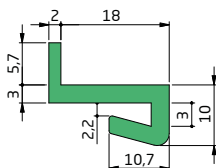

PZC 20-10 E | Cód.: 005096

PERFIL SERPENTINA

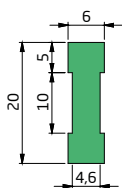

PRC 20-06 | Cód.: 005269

PERFIL CÔNICO

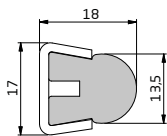

005191

PGC Cônico | Cód.: 005191

PERFIL PLANO

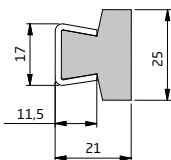

PGC Plano | Cód.: 006125

APLICAÇÃO

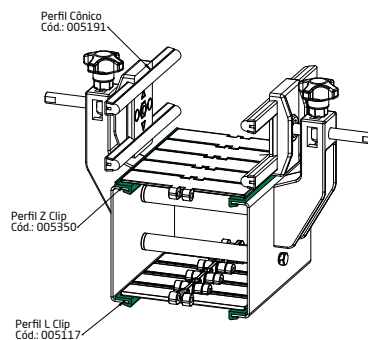
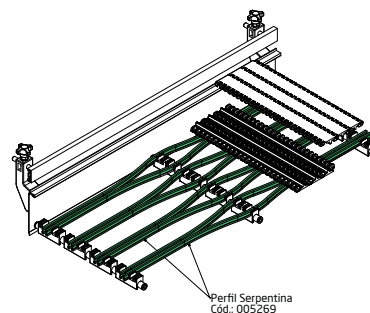
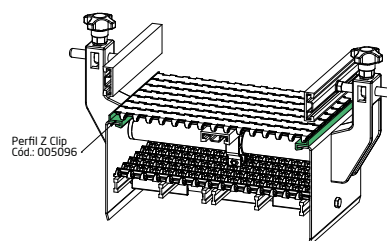
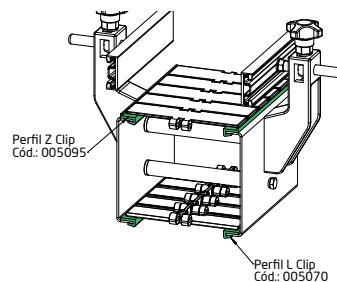

- PEAD - Polietileno de alta densidade.
- Consulte nosso Manual de Engenharia ou Serviço de Atendimento antes de aplicar nossos produtos.

TRANSPORTE RETO E CURVO

Material: Polietileno

PERFIL CENTRAL C

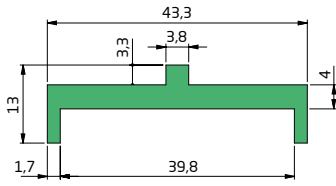

PCA 43-4 | Cód.: 005130

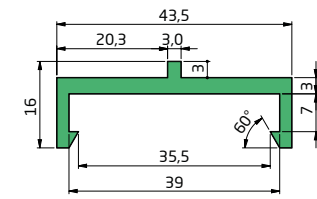

PGS 43-29 | Cód.: 005618

PERFIL C

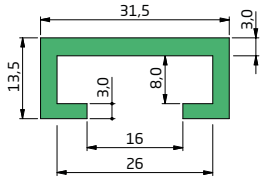

PG 31-16 | Cód.: 005140

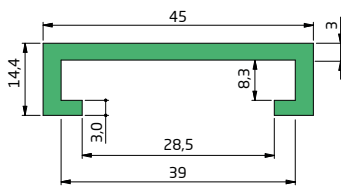

PG 45-28 | Cód.: 005145

AL PEFILL CLIP

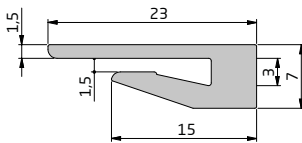

PC 23-7 | Cód.: 005127

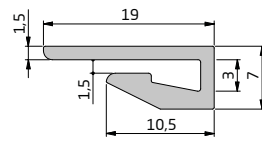

PC 19-7 | Cód.: 005168

PERFIL Z CLIP

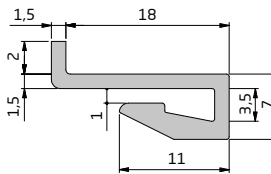

PZC 18-7 | Cód.: 005166

PERFIL C CLIP

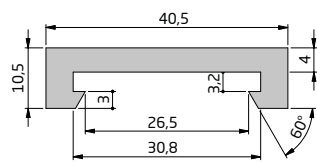

PG 40-27 | Cód.: 005155

PERFIL CLIP

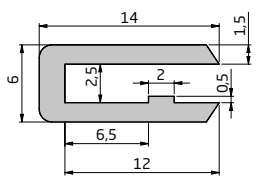

PC 14-6X | Cód.: 006033

APLICAÇÃO

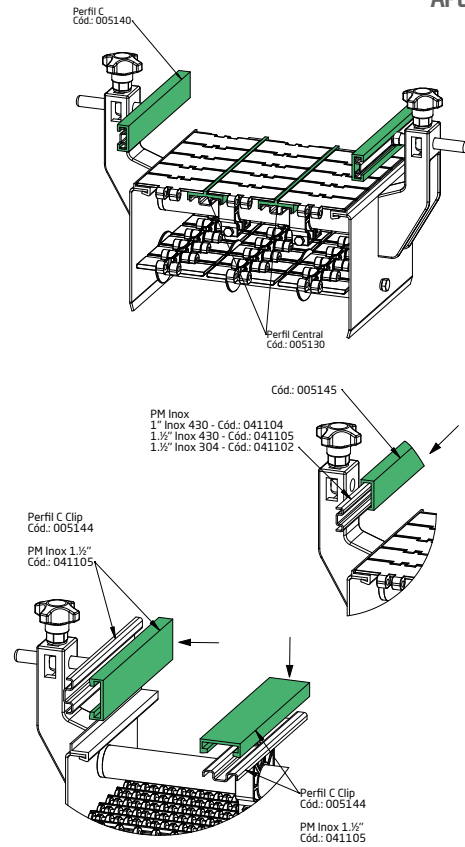

AL APLICAÇÃO EM TRANSPORTADORES DE ALUMÍNIO

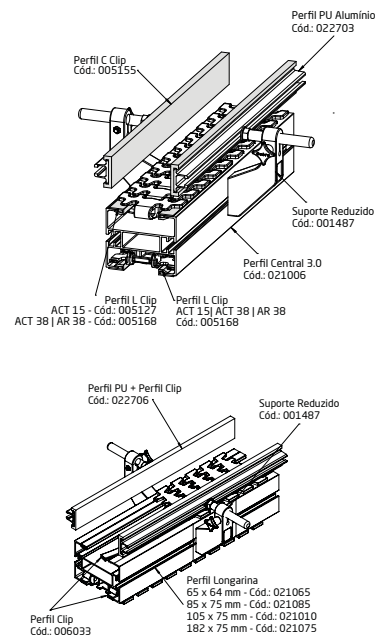

- PEAD - Polietileno de alta densidade.
- Consulte nosso Manual de Engenharia ou Serviço de Atendimento antes de aplicar nossos produtos.

TRANSPORTE RETO E CURVO

Material: Polietileno

PERFIL L CLIP

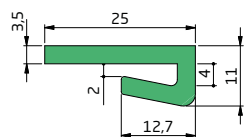

PLC 25-10 | Cód.: 005302

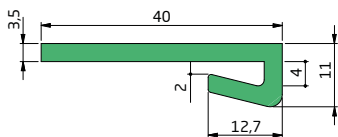

PLC 40-10 | Cód.: 005303

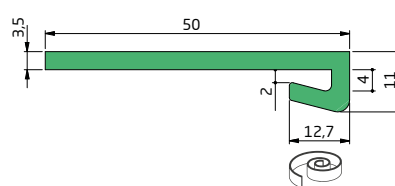

PLC 50-10 | Cód.: 005069

PERFIL C CLIP

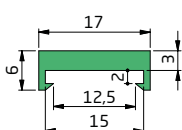

PG 17-12 | Cód.: 005304

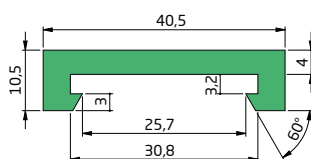

PG 40-27 | Cód.: 005151

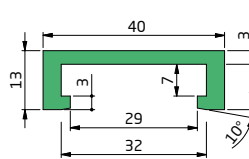

PG 40-29 | Cód.: 005142

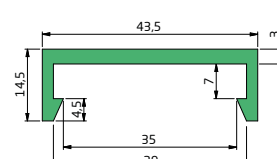

PG 43-34 | Cód.: 005144

PERFIL C

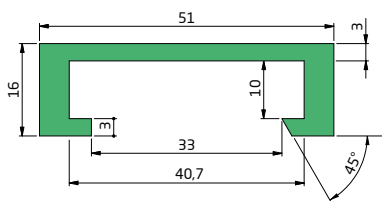

PG 50-33 | Cód.: 005147

PERFIL C

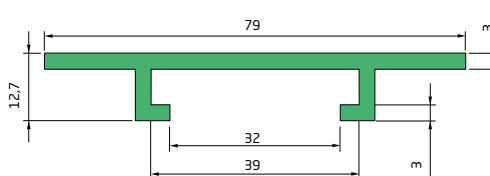

PGA 79-32 VD | Cód.: 005620

PGA 79-32 CZ | Cód.: 005537

PERFIL U

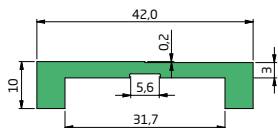

PU 42-31R | Cód.: 005115

PERFIL T

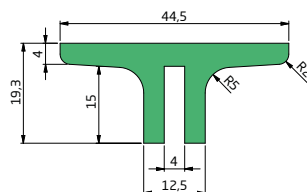

PTL 45-20 | Cód.: 005307

- PEAD - Polietileno de alta densidade.
- Consulte nosso Manual de Engenharia ou Serviço de Atendimento antes de aplicar nossos produtos.

TRANSPORTE RETO E CURVO

Material: Polietileno

PERFIL CLIP

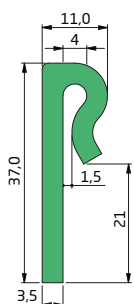

PCC 37-11 | Cód.: 005278 

PERFIL CLIP

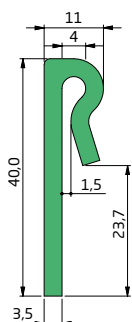

PCC 40-11 | Cód.: 005279 

PERFIL GUIA DUPLO

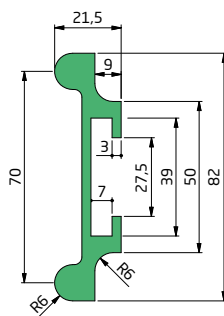

PGE 80-25 | Cód.: 005175 

PERFIL TUBO

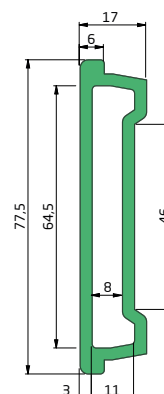

PGO 78-44 | Cód.: 005174 

- PEAD - Polietileno de alta densidade.
- Consulte nosso Manual de Engenharia ou Serviço de Atendimento antes de aplicar nossos produtos.

TRANSPORTE RETO E CURVO

Material: **Polietileno**

PERFIL L

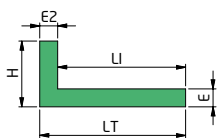

Código	Descrição	H (mm)	LT (mm)	LI (mm)	E (mm)	E2 (mm)
005060	PL 18-3	5,8	19,8	17,5	3,0	2,3
005061	PL 18-3 E	9,0	21,6	18,0	3,0	3,0
005080	PL 24-3	11,0	24,0	21,0	3,0	3,0
005062	PL 25-3 E	11,0	24,0	18,3	3,0	5,9
005082	PL 26-5 E	11,0	30,0	26,0	5,0	4,0
005311	PL 26-5	25,0	30,0	25,7	4,9	3,9
005063	PL 31-4	25,0	35,5	31,0	4,0	3,9
005312	PL 69-6	50,0	75,0	68,7	6,0	6,0

PERFIL Z

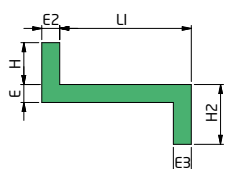

Código	Descrição	H (mm)	H2 (mm)	LI (mm)	E (mm)	E2 (mm)	E3 (mm)
005085	PZ 18-3	2,0	5,0	19,0	3,0	2,0	2,0
005086	PZ 21-3	3,3	6,3	21,0	3,0	5,5	3,0
005087	PZ 40-3	5,7	8,9	40,8	3,0	3,0	3,0
005092	PZ 22-3	6,5	10,0	22,0	3,0	3,0	3,0
005315	PZ 26-4	5,7	7,5	22,0	4,0	5,3	4,0

PERFIL C

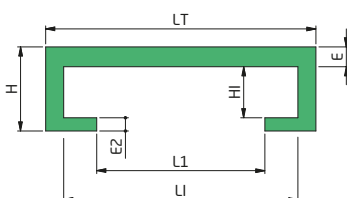

Código	Descrição	H (mm)	H1 (mm)	LT (mm)	LI (mm)	L1 (mm)	E (mm)	E2 (mm)
005316	PG 23-17	7,0	2,5	23,7	19,7	17,0	2,0	3,0
005163	PG 81-70	7,5	3,0	83,0	79,0	72,0	2,0	3,0
005177	PG 38-25	10,0	4,0	38,0	32,0	25,0	3,0	3,0
005319	PG 64-40	10,2	4,0	64,5	57,0	42,0	3,0	3,0
005143	PG 41-20	10,6	3,7	41,5	32,7	20,0	3,0	3,0
005321	PG 56-42	12,0	7,2	57,0	53,0	41,5	2,0	3,0
005322	PG 46-31	12,3	6,8	46,5	42,0	29,5	3,0	3,0
005148	PG 60-37	12,0	6,8	58,0	53,0	38,0	3,0	3,0
005139	PG 26-14	13,2	7,0	26,0	20,0	13,6	3,0	3,0
005146	PG 45-32	12,8	6,8	45,5	40,0	31,0	3,0	3,0
005140	PG 31-16	13,5	8,5	31,5	26,0	15,0	2,5	2,5
005145	PG 45-28	14,4	8,3	45,0	39,0	28,5	3,0	3,0
005326	PG 50-29	14,5	8,3	51,0	42,5	30,7	3,0	3,0
005149	PG 90-60	14,5	6,0	91,7	83,5	65,0	5,0	3,0
005329	PG 70-56	12,0	6,5	70,0	65,4	57,4	3,0	3,0

PERFIL C CLIP

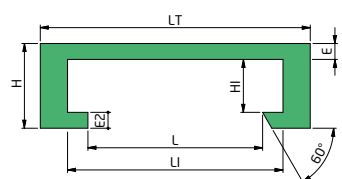

Código	Descrição	H (mm)	H1 (mm)	LT (mm)	LI (mm)	L (mm)	E (mm)	E2 (mm)
005328	PG 28-17	9,3	3,3	28,0	22,5	19,7	3,0	3,0
005330	PG 70-52	12,5	7,0	71,0	65,0	54,3	3,0	3,0
005147	PG 50-33	16,0	10,0	51,0	40,7	33,0	3,0	3,0



- PEAD - Polietileno de alta densidade.
- Consulte nosso Manual de Engenharia ou Serviço de Atendimento antes de aplicar nossos produtos.

TRANSPORTE RETO E CURVO

Material: Polietileno

PERFIL U

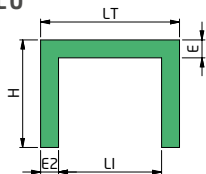

Código	Descrição	H (mm)	LT (mm)	LI (mm)	E (mm)	E2 (mm)
005331	PU 31-23 E	24,0	31,0	23,0	5,0	4,0
005107	PU 31-23	24,0	31,0	23,0	4,0	4,0
005333	PU 28-18	25,0	28,0	18,3	5,0	5,0

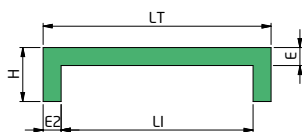

Código	Descrição	H (mm)	LT (mm)	LI (mm)	E (mm)	E2 (mm)
005102	PU 34-28	7,0	34,4	28,4	3,0	3,0
005105	PU 38-32	9,0	38,4	32,0	3,0	3,2
005106	PU 40-30	9,0	40,8	30,5	3,0	5,2
005103	PU 42-31	9,0	42,0	31,7	3,0	5,2
005334	PU 52-46	9,0	52,8	47,0	3,0	2,9
005101	PU 41-34	11,0	41,5	34,6	3,0	3,5
005104	PU 46-40	14,0	46,0	40,0	3,0	3,0
005108	PU 58-52	15,0	58,8	52,3	3,0	3,3

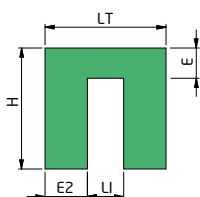

Código	Descrição	H (mm)	LT (mm)	LI (mm)	E (mm)	E2 (mm)
005110	PU 15-15	15,0	15,0	3,0	5,0	6,0
005336	PU 15-15 E	15,0	15,0	3,0	6,0	6,0
005292	PU 20-20 E	20,0	20,0	10,0	5,0	5,0
005337	PU 20-20 R	20,0	20,0	7,0	6,0	6,5
005338	PU 14-6	28,0	14,0	6,0	5,0	4,0
005339	PU 35-12 R	35,0	12,0	4,0	9,0	4,0

PERFIL C

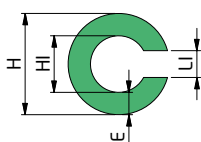

Código	Descrição	H (mm)	LT (mm)	LI (mm)	E (mm)
005340	RINSER PCR 12-8	12,0	8,0	4,5	2,3
005270	RINSER PCR 14-8	14,3	8,0	4,5	3,0
005341	RINSER PCR 15-9	15,0	9,0	4,0	3,0

PERFILL

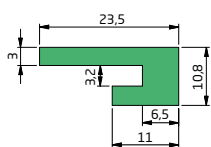

PLA23-10 | Cód.: 005075

PERFIL ISOLAMENTO

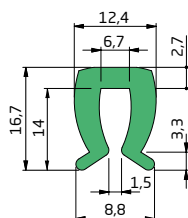

PI17-12 | Cód.: 005079

PERFIL T DUPLO

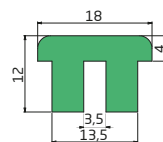

PTD18-12 | Cód.: 005219

PERFIL T DUPLO

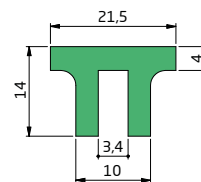

PTD21-15 | Cód.: 005220



- PEAD - Polietileno de alta densidade.
- Consulte nosso Manual de Engenharia ou Serviço de Atendimento antes de aplicar nossos produtos.

TRANSPORTE RETO E CURVO

Material: Polietileno

PERFIL RETO

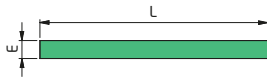

L (mm)	E 3 (mm)	Descrição	E 4 (mm)	Descrição	E 5 (mm)	Descrição
19,0	005010	PR 19-3	005011	PR 19-4	005012	PR 19-5
20,0	005015	PR 20-3	005016	PR 20-4	005017	PR 20-5
22,0	005020	PR 22-3	005021	PR 22-4	005022	PR 22-5
25,0	005025	PR 25-3	005026	PR 25-4	005027	PR 25-5
38,0	005030	PR 38-3	005031	PR 38-4	005032	PR 38-5
40,0	005035	PR 40-3	005036	PR 40-4	005037	PR 40-5
45,0	005040	PR 45-3	005041	PR 45-4	005042	PR 45-5
50,0	005045	PR 50-3	005046	PR 50-4	005047	PR 50-5



PERFIL CENTRAL

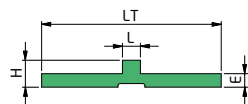

Código	Descrição	H (mm)	LT (mm)	LI (mm)	E (mm)
005289	PCS 26-10	5,0	26,0	10,0	3,0
005121	PCS 43-4	5,5	43,0	4,0	3,0
005124	PCS 52-12	5,5	52,0	12,0	3,0
005120	PCS 40-4	6,0	40,0	4,0	3,0
005122	PCS 45-6	6,0	45,0	6,0	3,0
005123	PCS 51-15	6,0	50,4	15,0	3,0
005119	PCS 64-18	6,0	64,0	18,0	3,0
005433	PCS 64-14	5,5	64,0	14,0	3,0



PERFIL CENTRALABA

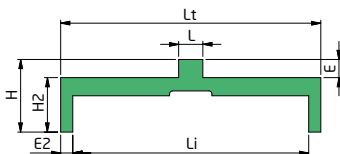

Código	Descrição	H (mm)	H2 (mm)	LT (mm)	L (mm)	LI (mm)	E (mm)	E2 (mm)
005131	PCA 50-3	11,0	8,0	51,0	3,4	45,5	4,0	2,8
005342	PCA 50-15	11,0	8,5	50,5	15,0	45,5	4,0	2,5
005138	PCA 45-5	11,5	9,0	45,6	5,0	39,0	4,0	3,3
005344	PCA 53-26	11,5	9,0	53,5	26,2	45,0	3,0	4,3
005345	PCA 62-20	11,5	9,0	62,0	20,0	52,0	3,0	5,0
005135	PCA 38-5	12,0	9,0	38,6	5,3	33,0	3,0	2,8
005130	PCA 43-4	13,0	9,7	43,3	3,8	39,8	4,0	1,8



PERFIL T DUPLO

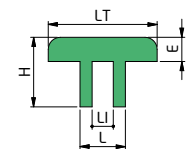

Código	Descrição	H (mm)	LT (mm)	L (mm)	LI (mm)	E (mm)
005369	PTD 18-16	16,5	18,0	13,5	3,5	4,0
005370	PTD 42-15	15,0	42,0	10,3	3,3	4,0
005234	PTD 45-31	31,0	44,2	14,5	4,5	5,7
005233	PTD 36-30	35,0	30,0	13,5	3,5	6,0



- PEAD - Polietileno de alta densidade.
- Consulte nosso Manual de Engenharia ou Serviço de Atendimento antes de aplicar nossos produtos.

TRANSPORTE RETO E CURVO

Material: Polietileno

PERFIL RETO



Código	Descrição	L (mm)	E (mm)
005346	PR 19-3	19,0	3,0
005051	PR 20-3	20,0	3,0
005347	PR 22-3	22,0	3,0
005053	PR 25-3	25,0	3,0
005348	PR 38-3	38,0	3,0
005530	PR 45-3	44,5	3,0
005034	PR 40-3	41,0	3,0

APLICAÇÃO

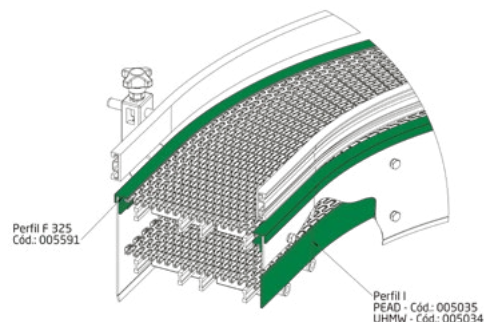

PERFIL Z CLIP

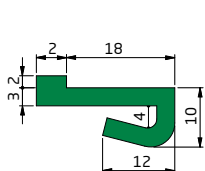

PZC 20-10 | Cód.: 005098

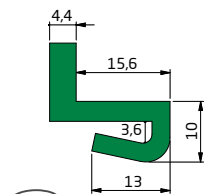

PZC 15-10 E | Cód.: 005351

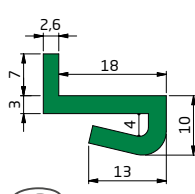

PZC 20-10 E | Cód.: 005350

Perfil Cônico
Cód.: 005191

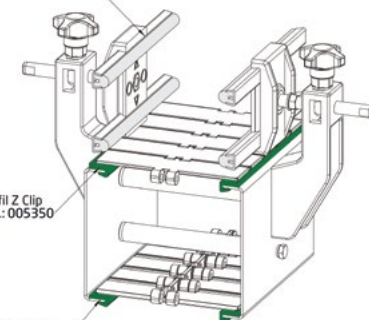

Perfil Z Clip
Cód.: 005350

Perfil L Clip
Cód.: 005117

PERFIL Z

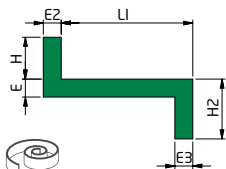

Código	Descrição	H (mm)	H2 (mm)	L1 (mm)	E (mm)	E2 (mm)	E3 (mm)
005089	PZ 18-3	2,0	5,0	19,0	3,0	2,0	2,0
005090	PZ 20-4	5,3	7,0	20,3	4,0	5,4	5,3
005349	PZ 22-5	4,5	9,5	21,9	5,0	3,0	3,0

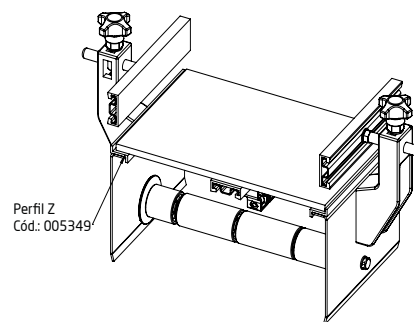

Perfil Z
Cód.: 005349

PERFIL L

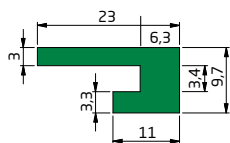

PLA 23-10 | Cód.: 005265

PERFIL L CLIP

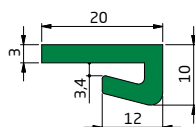

PLC 20-10 | Cód.: 005117



- UHMW - Polietileno de ultra alto peso molecular.
- Consulte nosso Manual de Engenharia ou Serviço de Atendimento antes de aplicar nossos produtos.

TRANSPORTE RETO E CURVO

Material: Polietileno

PERFIL F

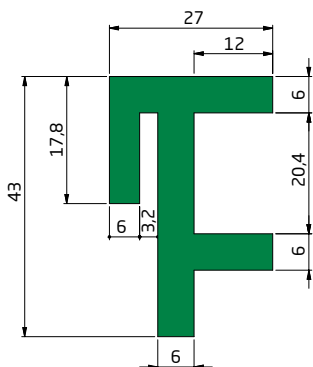

PF43-27 | Cód.: 005590 

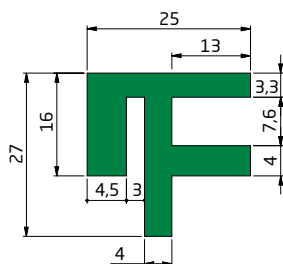

PF27-25 | Cód.: 005595 

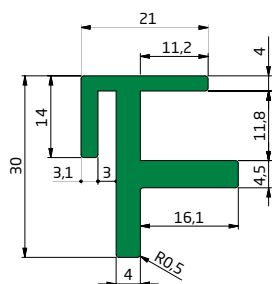

PF21-30 | Cód.: 005591 

APLICAÇÃO

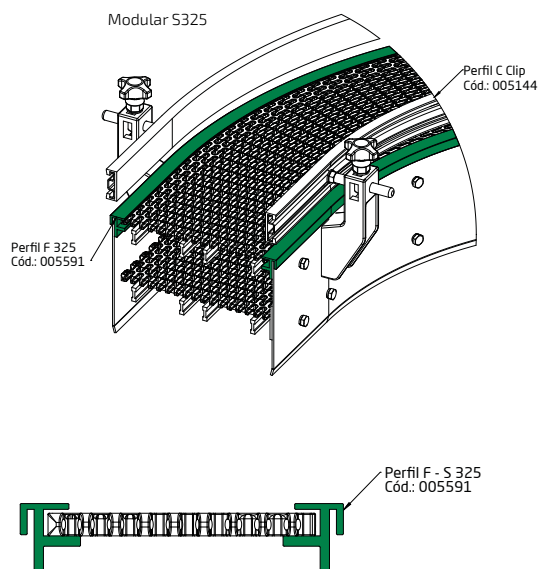
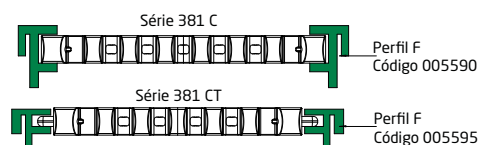
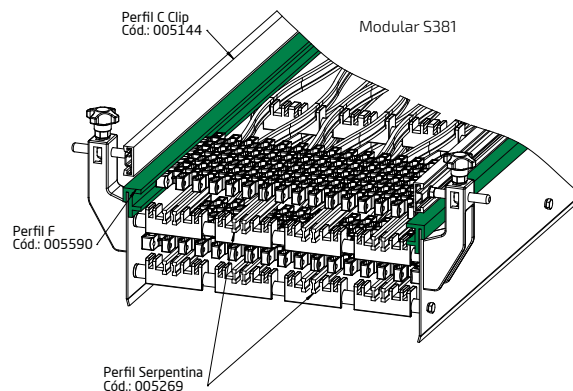

 barra: 3 metros

- UHMW - Polietileno de ultra alto peso molecular.
- Consulte nosso Manual de Engenharia ou Serviço de Atendimento antes de aplicar nossos produtos.

TRANSPORTE RETO E CURVO

Material: **Polietileno**

PERFIL U

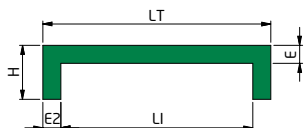

Código	Descrição	H (mm)	LT (mm)	LI (mm)	E (mm)	E2 (mm)
005560	PU 34-28	8,0	33,5	28,0	4,0	2,7
005353	PU 38-32	9,0	38,0	32,0	3,0	3,0
005354	PU 40-30	9,0	40,0	30,0	4,0	5,0
005226	PU 40-33	9,0	40,5	33,0	3,0	3,7
005228	PU 42-31	9,0	42,0	32,0	3,0	5,0
005355	PU 25-10	10,0	25,0	16,0	4,0	4,5
005356	PU 40-30 E	10,0	40,2	30,4	3,0	4,9
005357	PU 35-28	11,0	35,0	28,0	5,5	3,5
005358	PU 41-34	11,0	41,5	34,0	3,0	3,8
005359	PU 43-39	11,0	43,0	39,0	4,0	2,0
005360	PU 36-25	12,0	36,0	25,0	6,0	5,5
005361	PU 46-40	12,5	46,0	40,0	3,0	3,0
005362	PU 47-38	12,5	47,0	38,0	5,5	4,5
005235	PU 52-45	15,0	53,0	45,0	4,0	4,0
005363	PU 47-41	21,0	47,5	41,0	5,0	3,3
005364	PU 63-52	33,0	60,5	51,0	6,0	4,8
005352	PU 120-109	49,0	120,5	109,0	6,0	5,8

PERFIL U

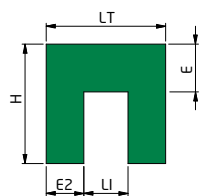

Código	Descrição	H (mm)	LT (mm)	LI (mm)	E (mm)	E2 (mm)
005365	PU 12-13	12,5	12,5	6,5	3,0	3,0
005366	PU 20-20 A	20,0	20,0	6,3	8,0	6,8
006367	PU 20-20 B	20,0	20,0	7,5	8,0	6,2
005215	PU 20-20 C	20,0	20,0	8,0	8,0	6,0
005256	PU 20-20 D	20,0	20,0	10,0	8,0	5,0
005368	PU 20-20 E	20,0	20,0	11,0	8,0	4,5

PERFIL U

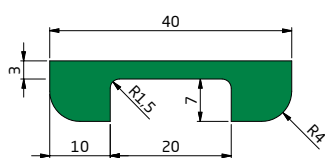

PU 40-20 | Cód.: 005371

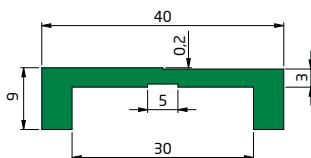

PU 42-31 R | Cód.: 005372

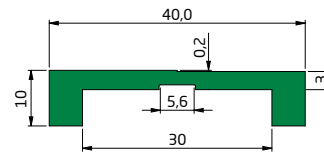

PU 40-30 R | Cód.: 005373

barra: 3 metros

- UHMW - Polietileno de ultra alto peso molecular.
- Consulte nosso Manual de Engenharia ou Serviço de Atendimento antes de aplicar nossos produtos.

TRANSPORTE RETO E CURVO

Material: **Polietileno**

PERFIL C

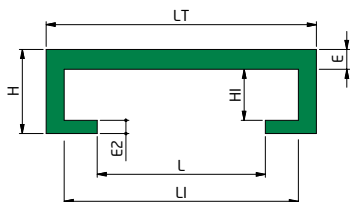

Código	Descrição	H (mm)	HI (mm)	LT (mm)	LI (mm)	L (mm)	E (mm)	E2 (mm)
005374	PG 42-30	9,0	3,5	42,0	37,0	30,0	3,0	2,5
005375	PG 36-24	10,0	2,0	36,0	28,0	24,0	5,0	3,0
005376	PG 38-26	9,8	2,6	38,0	32,5	26,0	3,5	3,5
005377	PG 70-40	10,5	4,5	70,0	57,0	40,0	3,0	3,0
005378	PG 40-29	12,4	6,4	40,0	32,3	29,0	3,0	3,0
005246	PG 45-32	12,0	6,7	45,0	39,0	32,0	3,0	2,5
005379	PG 61-41 E	12,5	6,0	62,0	52,0	41,0	3,5	3,0
005162	PG 80-39	12,0	5,5	80,0	52,0	39,0	3,5	3,0
005545	PG 61-41	13,0	7,0	61,5	52,0	41,0	3,0	3,0
005159	PG 45-28	14,0	8,5	45,0	39,0	28,0	3,0	2,2
005380	PG 50-26	14,0	8,5	50,0	41,0	26,0	3,2	2,3
005381	PG 50-29	14,5	8,7	50,0	41,5	26,0	2,8	3,0
005382	PG 50-34	28,3	20,3	50,0	42,5	34,0	4,0	4,0



PERFIL C CLIP

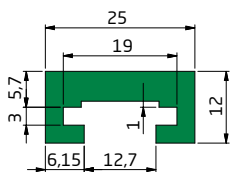

PG 25-13 | Cód.: 005383

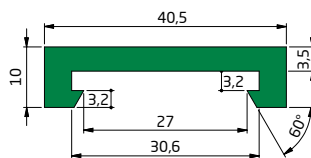

PG 40-27 | Cód.: 005384

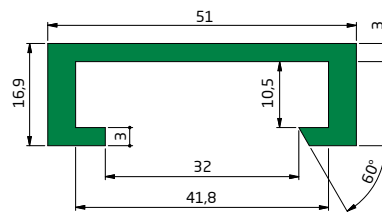

PG 50-33 | Cód.: 005385

PERFIL CENTRAL

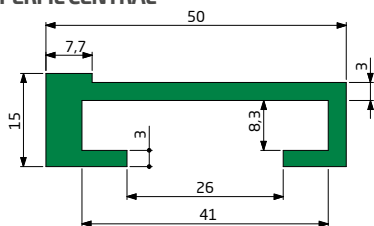

PGR 50-26 | Cód.: 005386

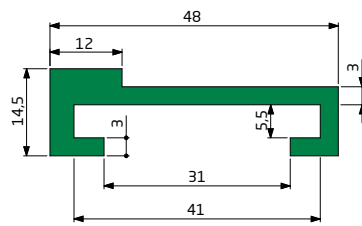

PRG 47-41 | Cód.: 005387

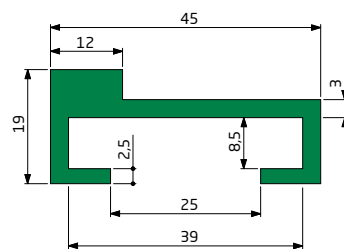

PGR 45-28 | Cód.: 005388

PERFIL CÔNICO

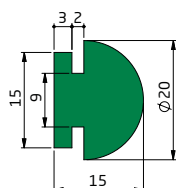

PGD 20-15 | Cód.: 005195

barra: 3 metros

- UHMW - Polietileno de ultra alto peso molecular.
- Consulte nosso Manual de Engenharia ou Serviço de Atendimento antes de aplicar nossos produtos.

TRANSPORTE RETO E CURVO

Material: Polietileno

PERFIL GUIA LATERAL

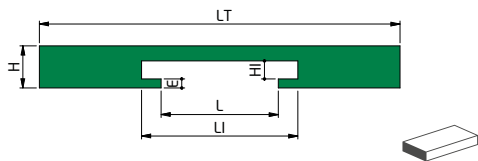

Código	Descrição	H (mm)	HI (mm)	LT (mm)	LI (mm)	L (mm)	E (mm)
005422	PGL 79-15	15,0	9,0	79,0	42,5	21,0	3,0
005390	PGL 120-14	14,0	6,0	120,0	52,0	39,0	3,0
005391	PGL 135-16	16,0	9,0	135,0	52,0	39,0	3,0
005392	PGL 135-16 E	16,0	6,0	135,0	52,0	39,0	3,0

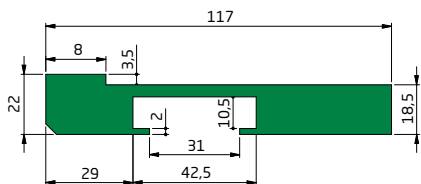

PGL 115-20 | Cód.: 005393

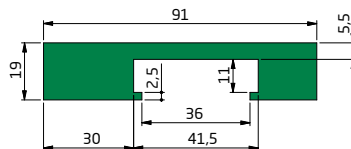

PGL 90-19 | Cód.: 005394

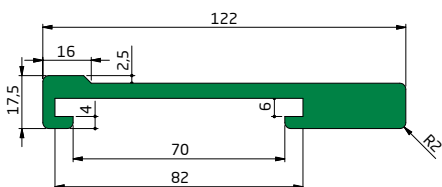

PGL 120-17 | Cód.: 005395

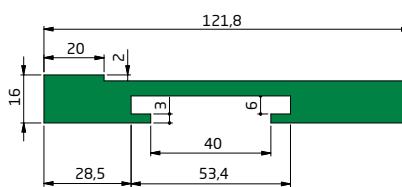

PGL 120-16 | Cód.: 005396

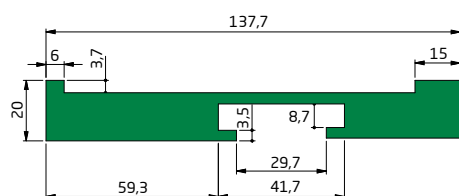

PGL 135-20 | Cód.: 005397

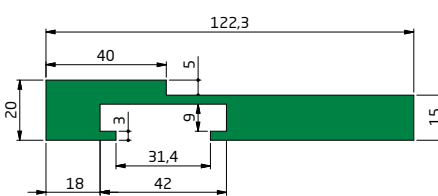

PGL 120-30 | Cód.: 005398

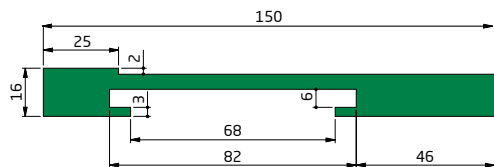

PGL 150-16 | Cód.: 005399

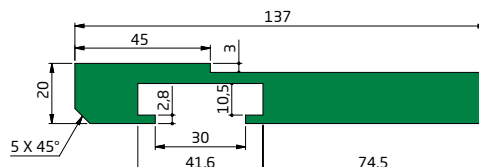

PGL 135-20 E | Cód.: 005400



- UHMW - Polietileno de ultra alto peso molecular.
- Consulte nosso Manual de Engenharia ou Serviço de Atendimento antes de aplicar nossos produtos.

TRANSPORTE RETO E CURVO

Material: **Polietileno**

PERFIL CENTRAL

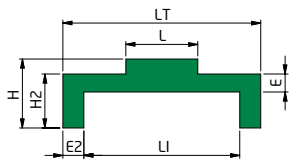

Código	Descrição	H (mm)	H2 (mm)	LT (mm)	LI (mm)	L (mm)	E (mm)	E2 (mm)
005401	PCA 33-12	11,5	9,0	33,0	26,0	12,0	3,0	3,5
005402	PCA 58-21	11,8	9,0	57,9	40,5	21,0	3,0	9,0
005403	PCA 48-16	15,5	13,0	48,0	41,5	16,0	3,0	3,0
005404	PCA 58-20	15,5	13,0	58,0	52,0	20,0	3,0	3,0
005405	PCA 72-20	15,5	13,0	72,0	66,3	20,0	3,0	3,0

PERFIL CENTRAL

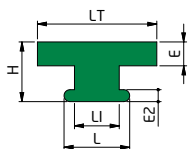

Código	Descrição	H (mm)	LT (mm)	LI (mm)	L (mm)	E (mm)	E2 (mm)
005284	PT 20-10	10,0	20,0	7,5	11,0	4,0	2,0
005406	PT 20-11	10,6	20,0	7,5	10,7	4,7	2,0
005407	PT 30-11	11,0	30,0	7,5	11,0	5,0	2,0
005408	PT 25-13	13,0	25,0	7,5	11,0	7,0	2,5

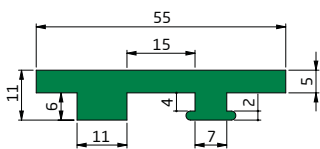

PTD 55-11 | Cód.: 005409

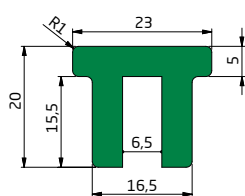
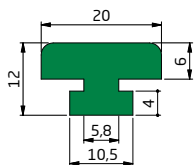

PTD 23-20 | Cód.: 005410

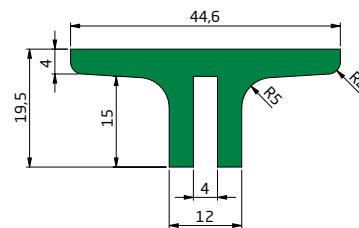
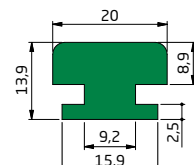

PTL 45-20 | Cód.: 005411

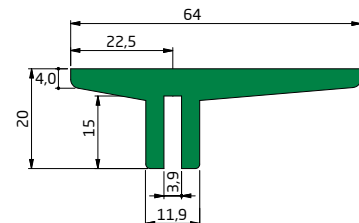

PT 20-12 | Cód.: 005413

PT 20-14 | Cód.: 005414

PTL 64-20 | Cód.: 005412

PERFIL CLIP

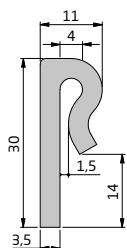

PCC 30-11 | Cód.: 005296

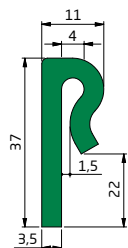

PCC 37-11 | Cód.: 005540

PERFIL AÉREO

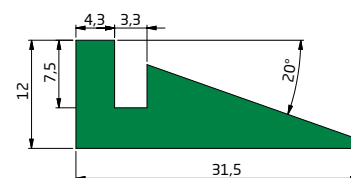

PTA 32-12 | Cód.: 005250

- UHMW - Polietileno de ultra alto peso molecular.
- Consulte nosso Manual de Engenharia ou Serviço de Atendimento antes de aplicar nossos produtos.

TRANSPORTE RETO E CURVO

Material: Polietileno

PERFLAÉREO

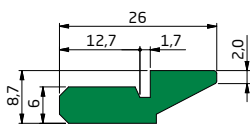

PET 26-8 | Cód.: 005415 

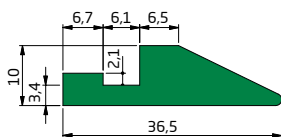

PTA 36-10 | Cód.: 005251 

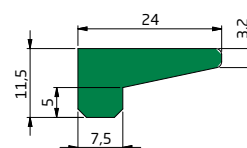

PTA 24-11 | Cód.: 005252 

PERFIL VIRA LATAS

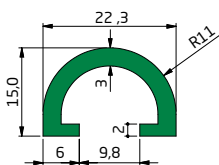

PVL 22-8 | Cód.: 005257 

PERFIL GUIA

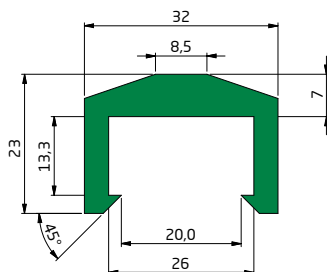

PG 32-20 | Cód.: 005547 

PERFIL GARGALO

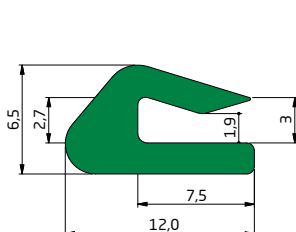

PET 12-6 | Cód.: 005418 

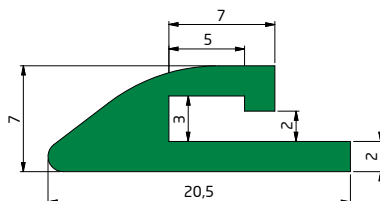

PET 20-7 | Cód.: 005419 

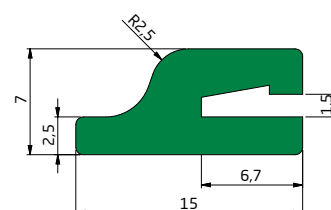

PET 15-7 | Cód.: 005420 

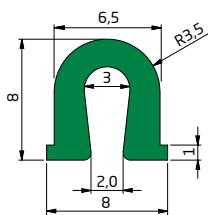

PET 7-2 | Cód.: 005421 



- UHMW - Polietileno de ultra alto peso molecular.
- Consulte nosso Manual de Engenharia ou Serviço de Atendimento antes de aplicar nossos produtos.